

Neubau Sporthalle Wöllstadt

21023

Neubau Sporthalle Wöllstadt

Ausgangssituation



Lageplan M 1:2000

21023

Neubau Sporthalle Wöllstadt

2-Feld V1



Lageplan M 1:2000

21023

Neubau Sporthalle Wöllstadt

2-Feld V1

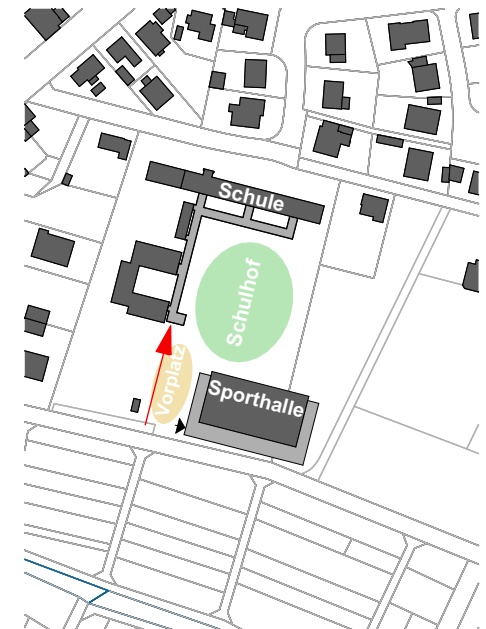
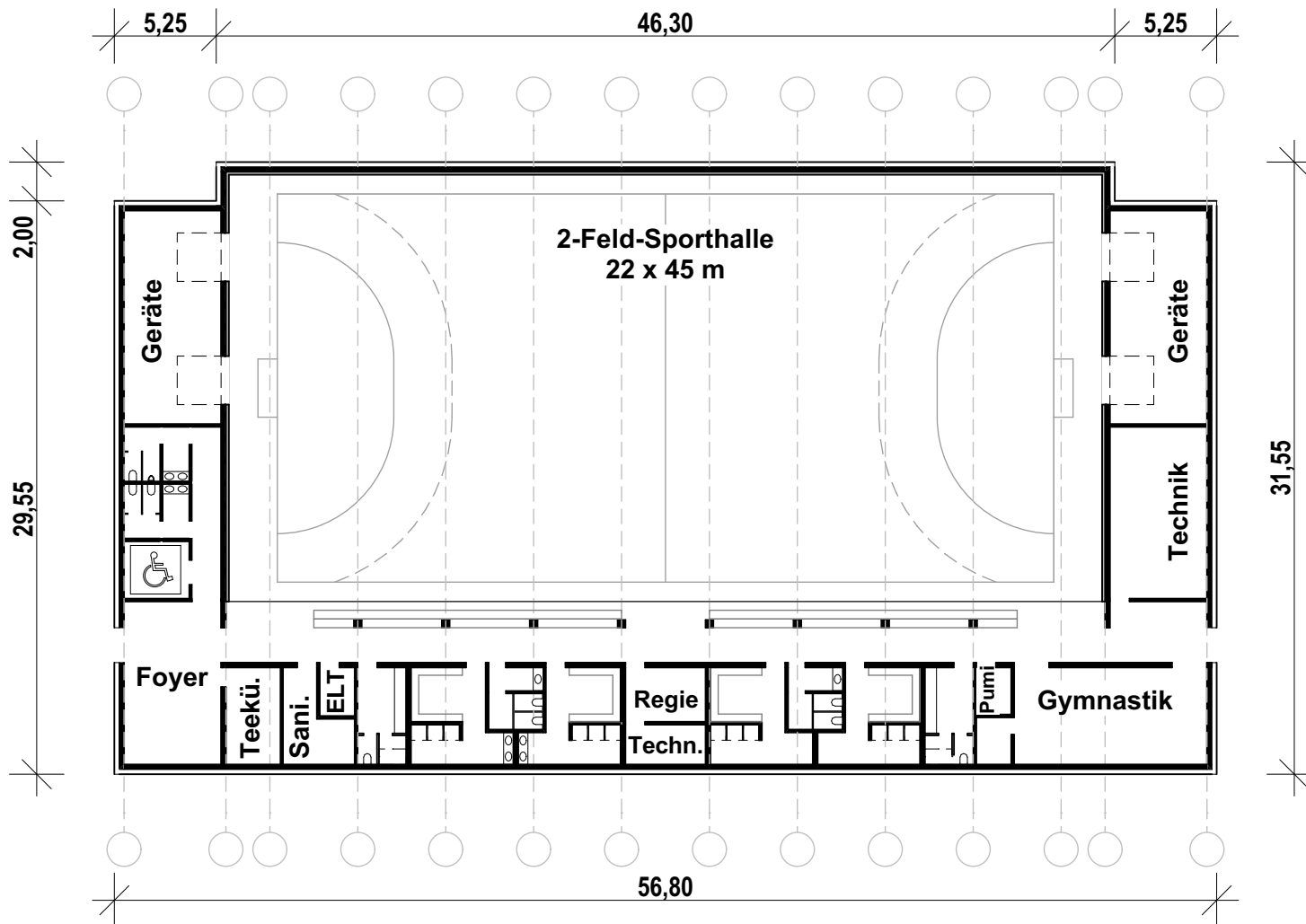

BGF - ca. 1.770 m²
BRI - ca. 12.650 m³

Beispiel-Grundriss M 1:350

21023

Neubau Sporthalle Wöllstadt

2-Feld V2



Lageplan M 1:2000

21023

Neubau Sporthalle Wöllstadt

2-Feld V2

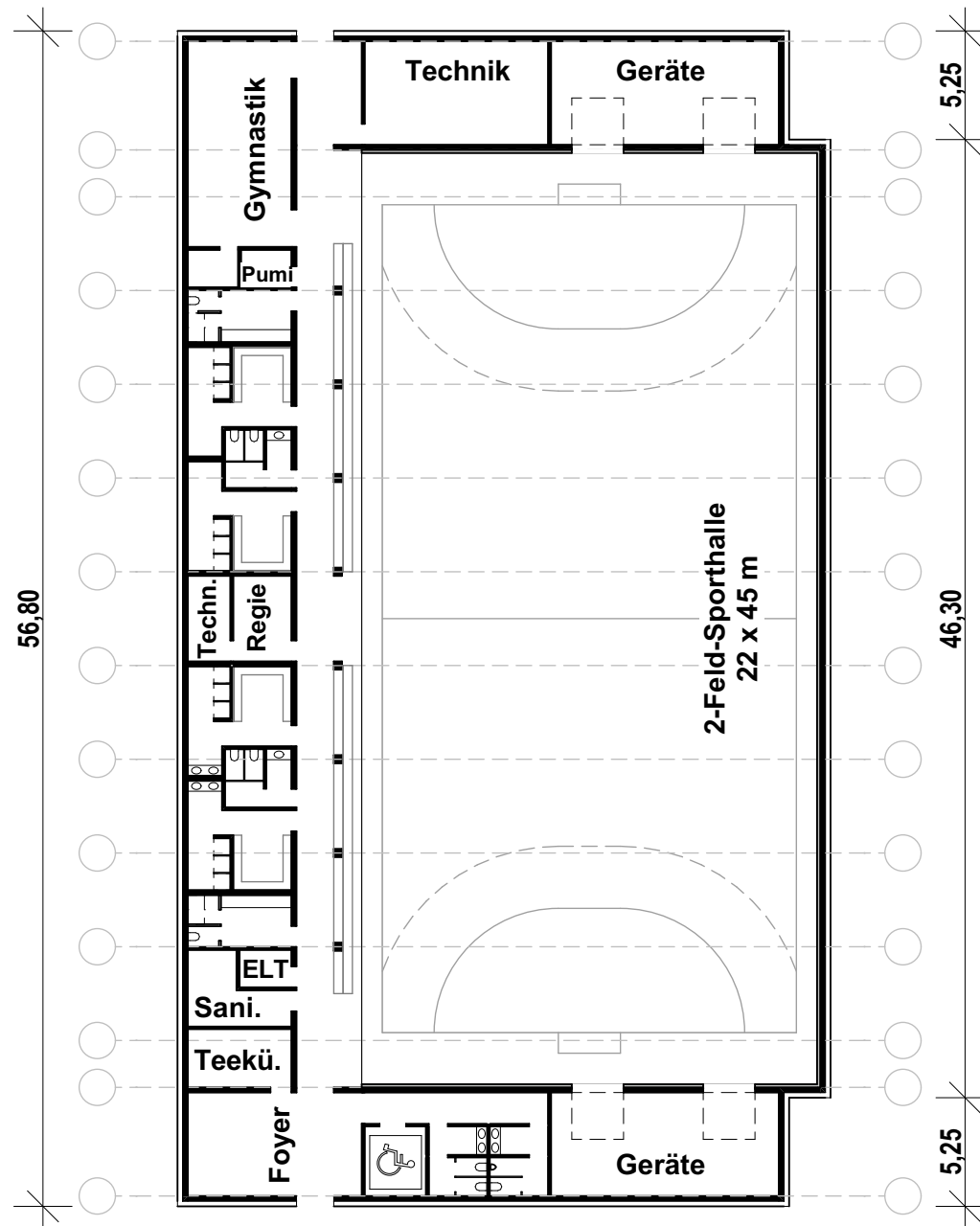

Beispiel-Grundriss M 1:350

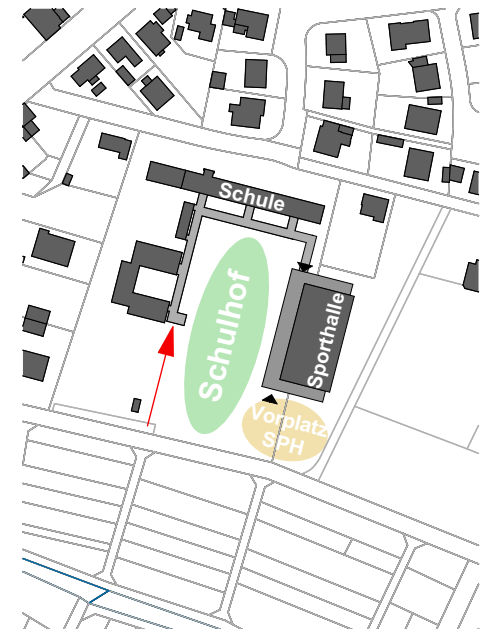

BGF - ca. 1.770 m²
BRI - ca. 12.650 m³

21023

Neubau Sporthalle Wöllstadt

3-Feld V1



Lageplan M 1:2000

21023

Neubau Sporthalle Wöllstadt

3-Feld V1

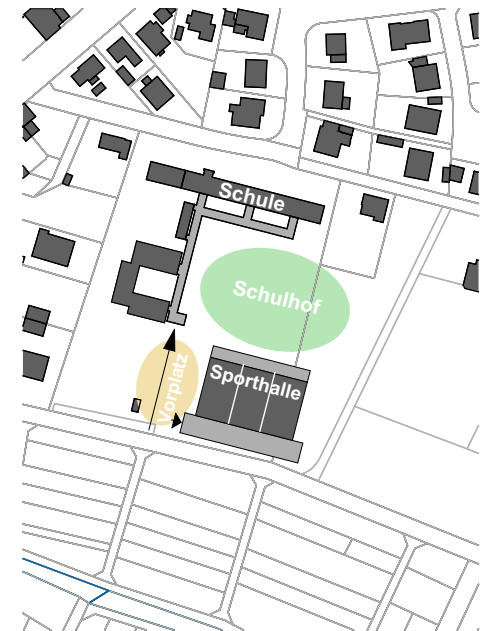
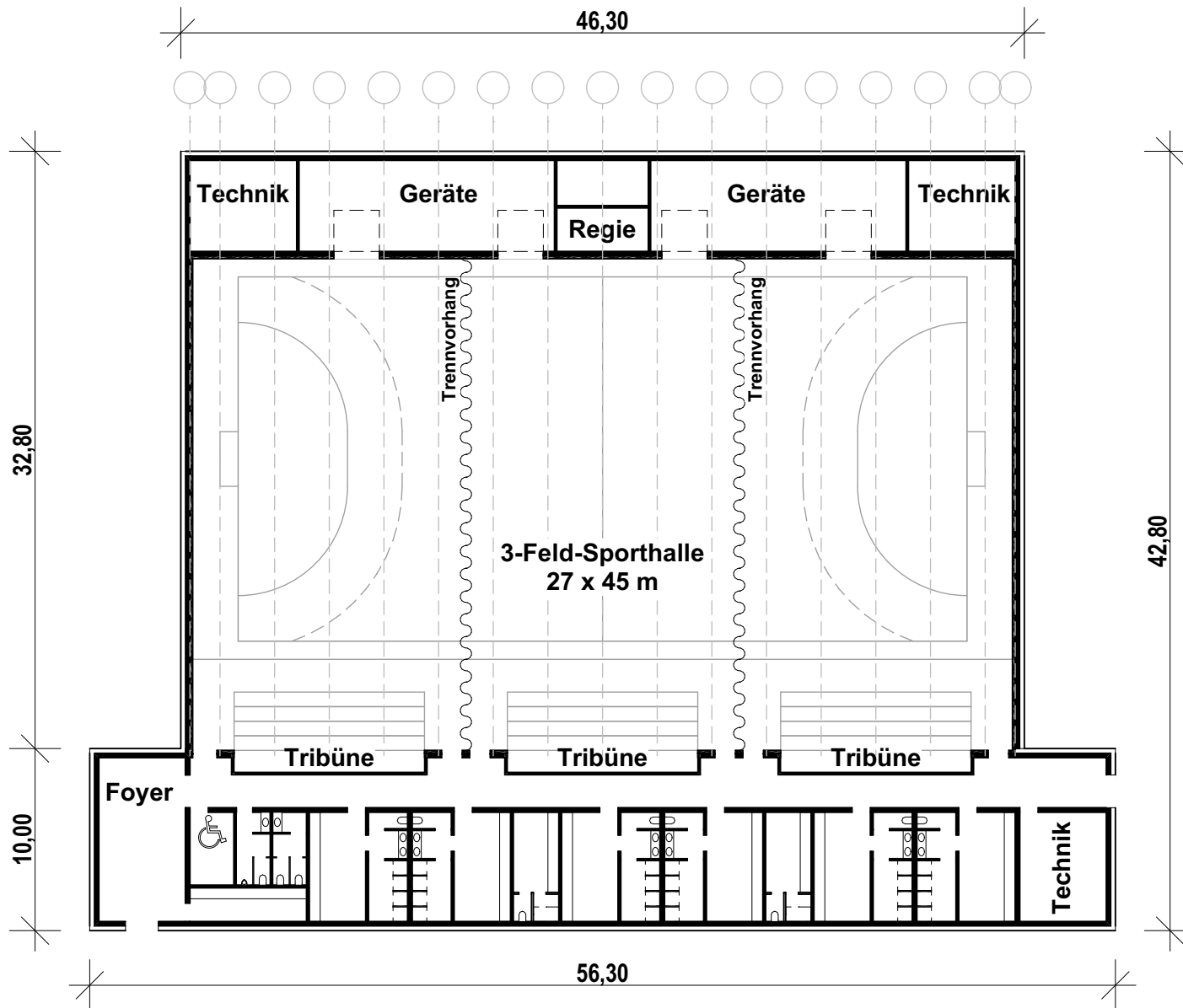

BGF - ca. 2.082 m²
BRI - ca. 14.760 m³

Beispiel-Grundriss M 1:350

21023

Neubau Sporthalle Wöllstadt

3-Feld V2



Lageplan M 1:2000

21023

Neubau Sporthalle Wöllstadt

3-Feld V2

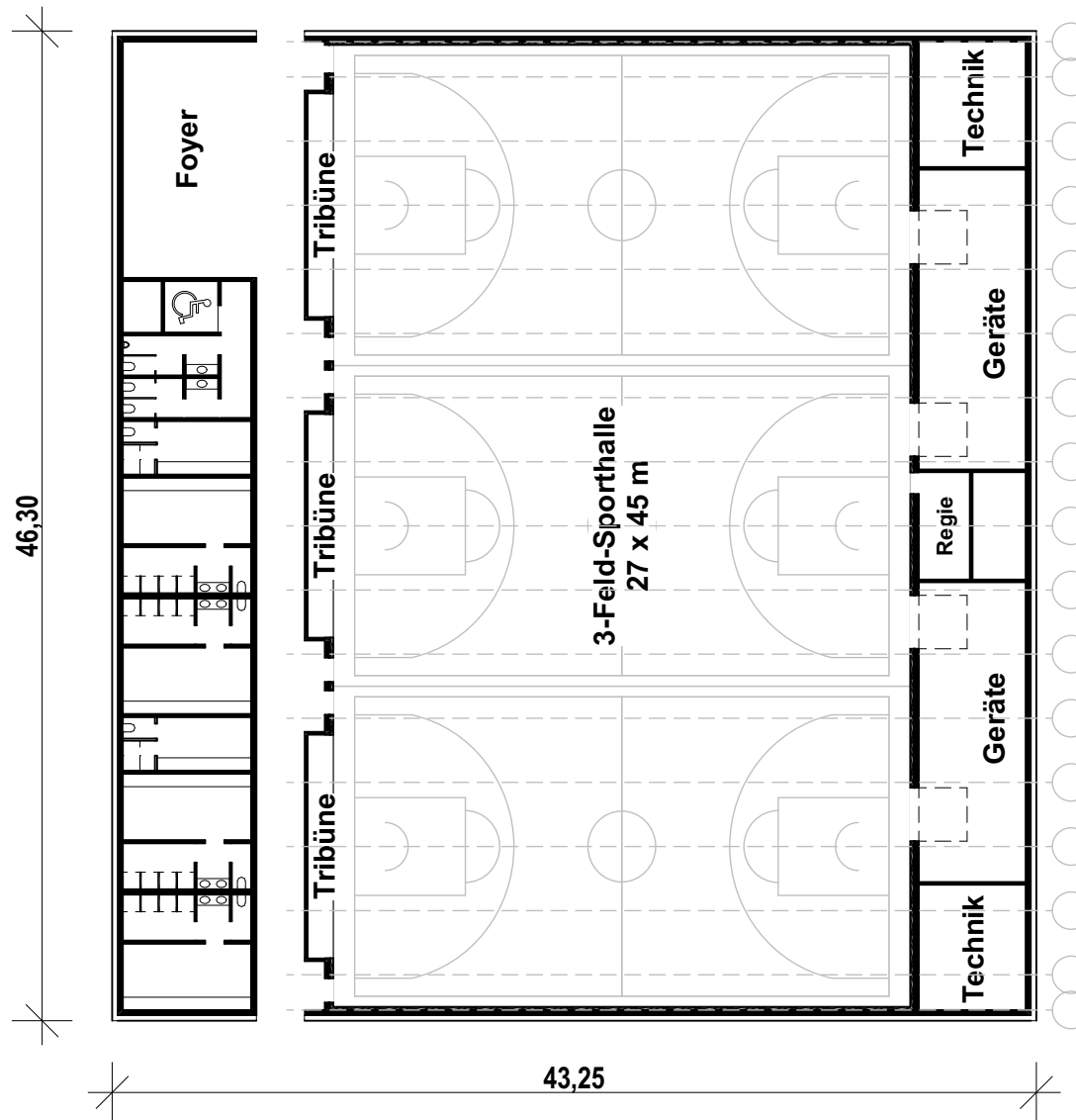

Beispiel-Grundriss M 1:350



BGF - ca. 2.002 m²
BRI - ca. 14.440 m³